

ACCESS

Rinkokaku in Maebashi city, Gunma prefecture (3-15 Otemachi, Maebashi City)

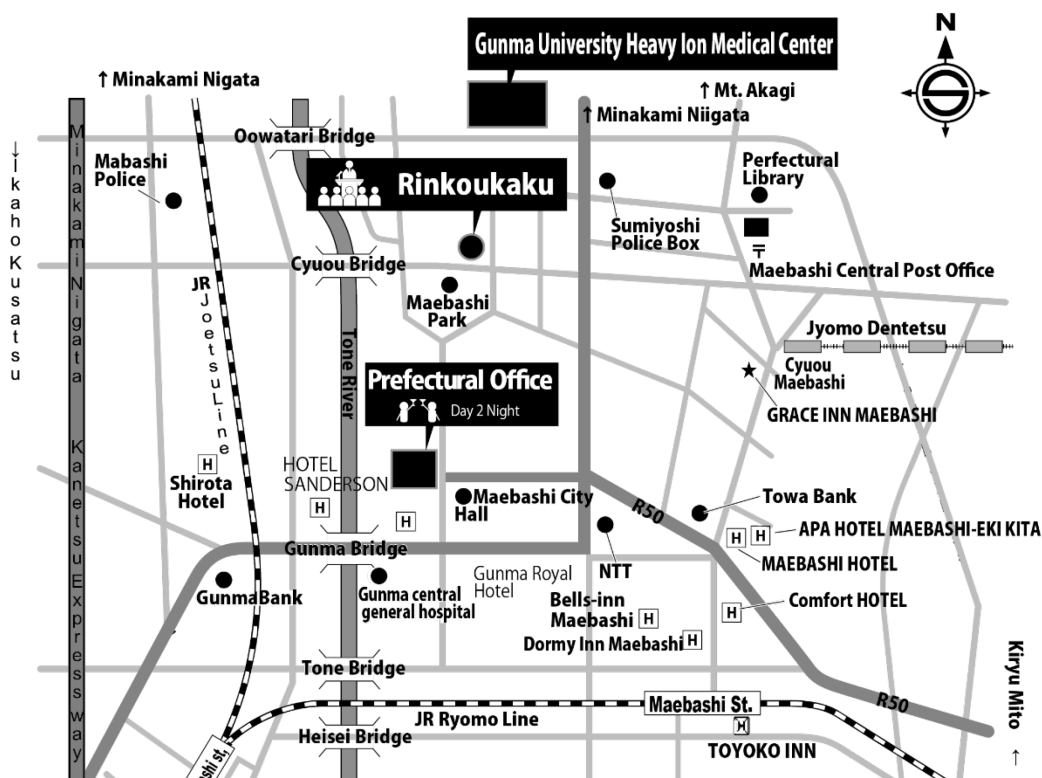

From Maebashi St. To Rinkokaku

- 10 minutes by bus (Nippon Chuo Bus Maebashi-Shinto Line) from JR Maebashi Station, get off at the Luna Park Rinkokaku-mae bus stop, and walk 1 minute.
- 6 minutes by cab.

From Airport To Maebashi Station

By Train

- Narita Airport --- (60min.) --- Tokyo St. --- (50min.) --- Takasaki St. --- (15min.) --- Maebashi St.
- Hanea Airport --- (40min.) --- Tokyo St. --- (50min.) --- Takasaki St. --- (15min.) --- Maebashi St.

By Bus

- Narita Airport ----- "AZAREA EXPRESS (210min.) ----- Maebashi St.
- Hanea Airport ----- "Airport limousine Bus (210min.) ----- Maebashi St.

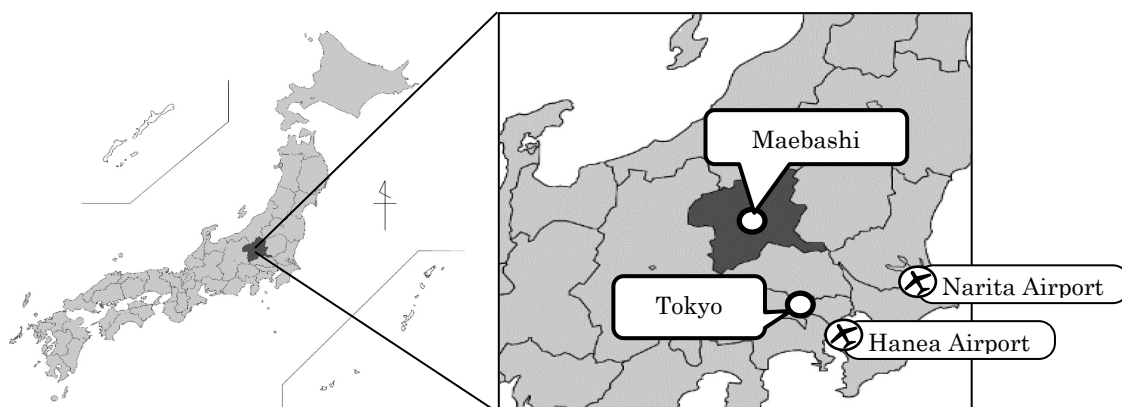

VENUE INFORMATION

2nd floor

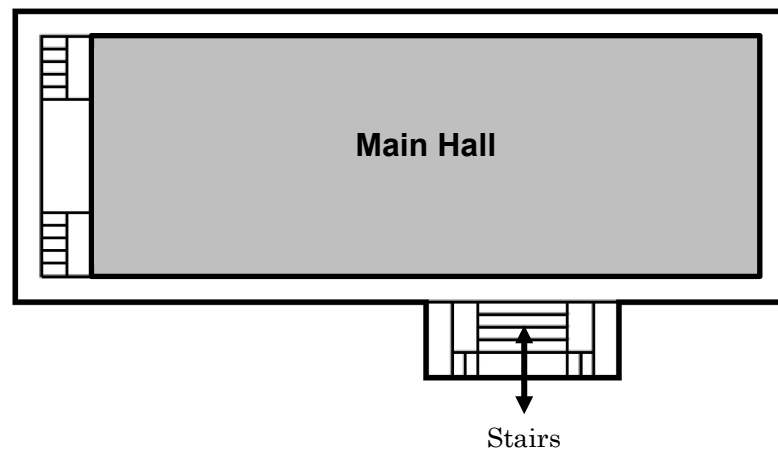

1st floor

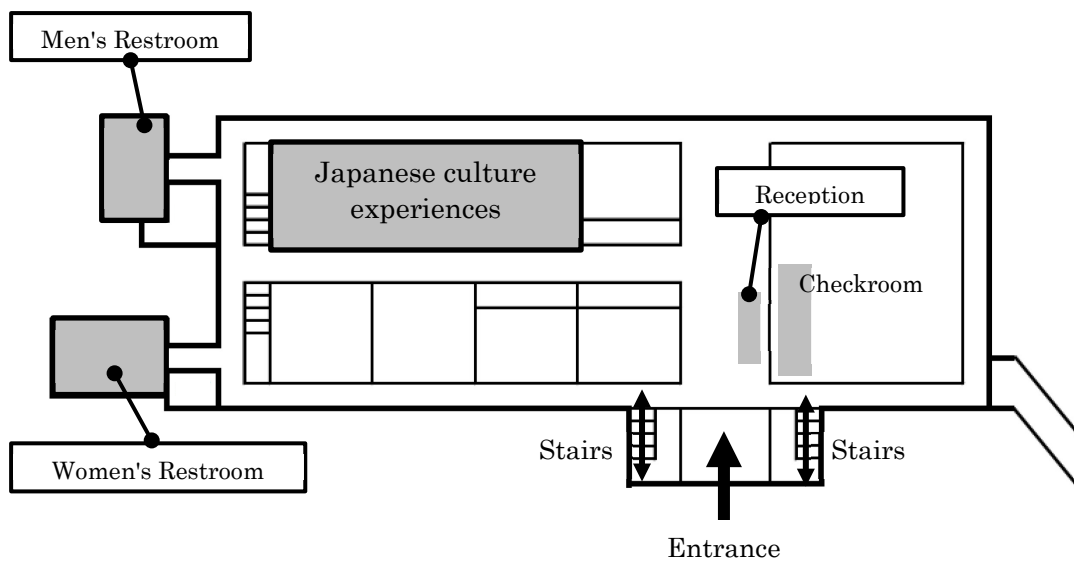

- It is a National Important Cultural Property.
- Smoking is prohibited on the premises and there is no smoking area. In principle, no fire stoves, solid fuels, or other flammable items are allowed in the museum.
- Visitors are required to take off their shoes to enter the museum.
- Please ask the manager if you want to open the door of the porch. The locks are of fragile construction. Please do not attempt to open the locks by yourself.